

Blinky™

Philadelphia Scientific offers a complete selection of battery water level monitors: The *Blinky* Range, so you can be reassured you have chosen the optimal solution for your application and budget.

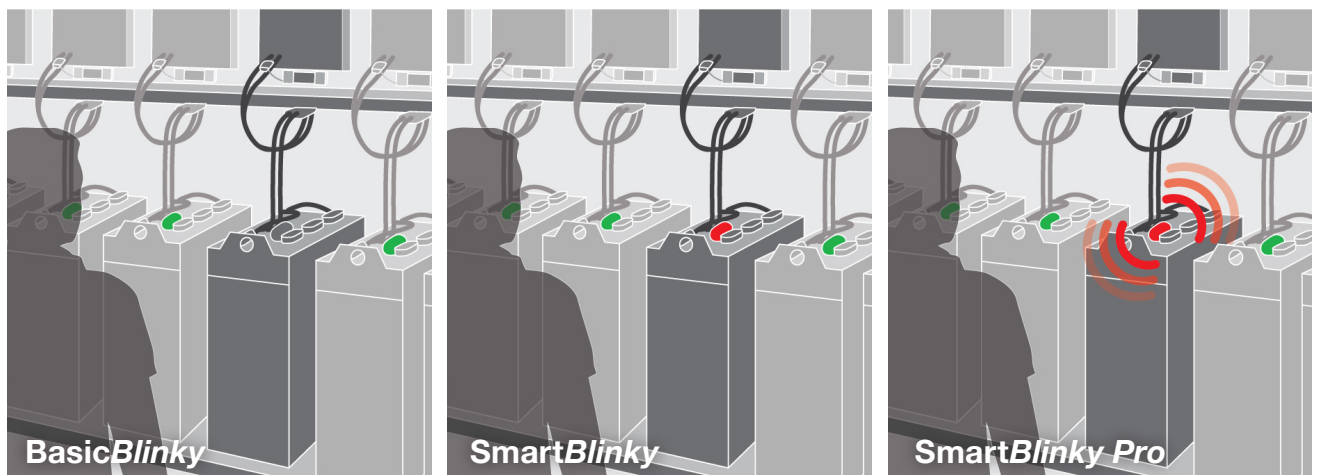

Let your batteries tell you when they need water.

The *Blinky*™ range of battery water level monitors (BWM) features patented UL Classified® technology that dramatically improves battery maintenance by intelligently alerting personnel when a battery needs water.

The new super bright LED light indicator and audible alarm (Pro unit) eliminate operator error by clearly indicating when a battery has sufficient electrolyte.

Philadelphia Scientific has three tiers of battery water level monitors to suit all applications and budgets:

- *BasicBlinky* is the entry level battery water level monitor. It has provided decades of protection against battery dry out and remains the industry leading low-cost battery monitor.
- *SmartBlinky* is our mid-range battery water level monitor and offers comprehensive functionality for great value. The unique SmartDelay feature provides 100% confidence of a true indication.
- *SmartBlinky Pro* adds an audible alarm and fool proof installation to SmartDelay, making *SmartBlinky Pro* the gold standard for battery monitors.

Features

- ✓ New super bright LED lights make our *Blinkys* much more visible.
- ✓ Stronger LED housing and low profiles on the battery reduce the chance of breakage during service.
- ✓ Wide operating voltages and 'forgiveness' zones make *Blinkys* suitable for Monobloc batteries and ensure breakage through incorrect installation is minimised.

Features and benefits summary

	Basic <i>Blinky</i>	Smart <i>Blinky</i>	Smart <i>BlinkyPro</i>
Indication	OK: Green Fill now: No light	OK: Green with pulse Fill soon: Solid green/red with red flash Fill now: Red asymmetric warning flash Refilled: Green flash	OK: Green heartbeat Fill soon: Green/red heartbeat Fill now: Red asymmetric warning flash Refilled: Green flash
LED	Super bright LED	Super bright LED	Matrix of four super bright LEDs
Audible alarm	No	No	Yes
SmartDelay	No	Yes	Yes
Days without water indicator	No	No	Yes
Operating voltage	4.0v	4.0v to 12.0v	Universal
Forgiveness zone	7.0v to 18.0v hibernates	14v to 16.0v hibernates	N/A
Nominal current	28.0mA	2.67mA	@ 24V 20mA, @ 48V 10mA, @ 80V 5mA
Anycell installation	No	No	Yes
Reverse polarity	No	No	Yes
Reverse polarity protection	Yes	Yes	N/A
Versions	Standard - LED on the probe	Standard: LED on the probe Remote: LED located anywhere on battery Cyclops: LED mounts between the cables Detachable: Allows the LED to be mounted anywhere. Interface: A 'clean contact' output for connection to 3rd party devices	Standard: LED on the battery Remote: LED mounted between the cables
Connections	(B) M10 steel ring (S) M4 steel ring & screw (Q) FlexiTap piercing	(B) M10 steel ring (S) M4 steel ring & screw (Q) FlexiTap piercing	(S) M4 steel ring & screw (Q) FlexiTap piercing
Fuses	B & S - 1, Q - 2	B & S - 2, Q - 3	B & S - 2, Q - 3
Flame retardant	UL V-0	UL V-0	UL V-0
Certification	UL, C-Tick, CE Mark	UL, C-Tick, CE Mark	UL, C-Tick, CE Mark
6v and 12v Monobloc	No	Yes	Yes
Weight	90.7 grams	90.7 grams	120 grams
Housing dimensions	L = 27 mm W = 12 mm H = 15 mm	L = 33 mm W = 12 mm H = 14 mm	L = 62 mm W = 32 mm H = 25 mm
Warranty	1 year	1 year	1 year
Generation	Third	Third	First
ROI week	9	18	20



www.phlsci.com

Philadelphia Scientific Americas
207 Progress Drive, Montgomeryville, PA, 18936 USA
P: +1 (0) 215 616 0390 F: +1 (0) 215 616 0500

Philadelphia Scientific EMEA
188 Oxford Grove, Bolton, BL1 3BH, UK
P: +44 (0) 1204 467777 F: +44 (0) 1204 493300

Philadelphia Scientific Asia Pacific
2/17 Norman Street, Peakhurst, NSW, 2210, Australia
P: +61 (0) 2 8004 2447 F: +61 (0) 2 9012 0383